

Pos. Nr. Pos. no.	Beschreibung Description	Art.-Nr. Art. no.	Preisgruppe Price bracket
1	Motor Motor	85125	55
2	Kardanschale Cardan bearing	87104	3
3	Kardanschale 8,0 mm Cardan bearing 8,0mm	87152	2
4	Steckplatine Printed	87829	20
5	Platine komplett Printed circuit assembly	87859	38
6	TS-Gehäuse Part set body	200039	20
7	Lichtleitstäbesatz Light transmission bar set	107656	10
8	Lichtabdeckungsatz Light cover set	109328	6
9	Drahtlampe T3/4 16V 30mA Light bulb T3/4 16V 30mA	108616	10
10	GF-Schraube M2x5 GF-Screw M2x5	114966	2
11	Puffer gewölbt Buffer vaulted	107659	4
12	Puffer flach Buffer flat	107658	4
13	Gehäuse komplett Betr. Nr.232 446-5 Body assembly no. 232 446-5	129383	60
14	Stirnfenster + Seitenfenster Front window + side window	129384	20

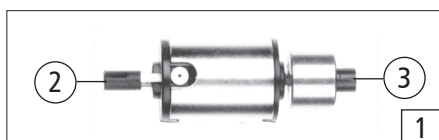

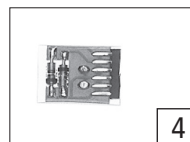
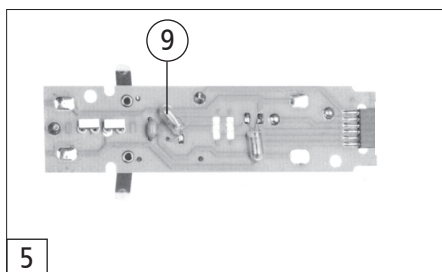
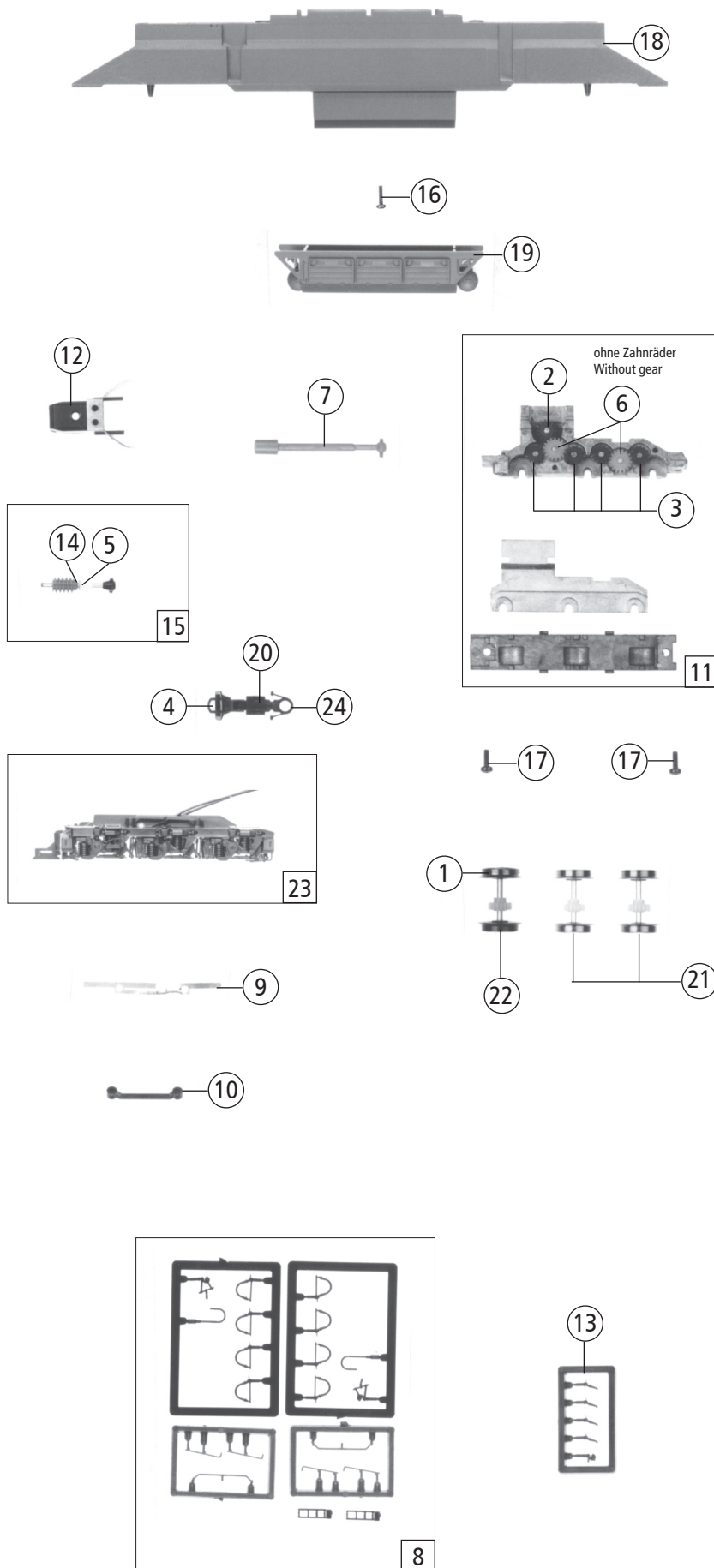

Pos. Nr. Pos. no.	Beschreibung Description	Art.-Nr. Art. no.	Preisgruppe Price bracket
1	Hafring N 8-10mm 0,3 10Stk. Traction tyre set 10pieces	85611	---
2	Schneckenzahnrad Z=19/14 M=0.3 Gear Z=19/14 M=0.3	86400	3
3	Zahnrad Z=14 gerade M=0.3 rot Gear Z=14 gerade M=0.3 red	86496	2
4	TT-Standardkupplung Standard coupling	124371	6
5	Schneckenlager Worm axle bearing	89750	4
6	Zwischenzahnrad Z=17 Gear between Z=17	97738	3
7	Kardanwelle Cardan shaft	107646	3
8	Zurüstbeutel Bag with accessories	200037	15
9	Radkontakt Wheel current contact strip	108045	3
10	Kontakthalter Contact holder	124458	2
11	Getriebesatz ohne Zahnräder Gear part set without gears	200032	24
12	Schneckendeckel Worm cover	108051	8
13	Bremsschlauch+Kupplungshaken Air-brake hose and coupling hook	109329	6
14	Scheibe Disc	112394	3
15	Schneckensatz Worm set	86979	24
16	Schraube M1,6x6 Screw M1,6x6	113069	2
17	GF-Schraube M1,6X4 GF-Screw M1,6x4	114850	2
18	Grundrahmen Frame	123539	23
19	Tank Tank	127969	3
20	Kupplungsdeckel Coupling cover	109332	2
21	Radsatz m. Zahnrad ohne Hafring Wheelset with gear without traction tyre	109323	16
22	Radsatz mit Zahnrad mit 2 Hafringen Wheelset with gear with traction tyre	109324	18
23	Blende komplett Bogie frame assembly	109325	23
24	Kupplungskammer Coupling chamber	109331	2